

West Tower

Tower Plan Level 1

Grande Vista Level

Above 5 levels of parking

The above drawings are conceptual only and are subject to change without notice at the discretion of the developer. The developer reserves the right to make any additions, deletions and modifications to the drawings as the developer may deem appropriate or desirable. Dimensions and square footages are approximate and may vary with actual construction. Furniture depicted is for conceptual consideration. Oral representations cannot be relied upon as correctly stating representations of the developer. For correct representations make reference to the documents required by section 718.503, Florida Statutes, to be furnished by a developer to a buyer or lessee.

Note: Grande Vista (GV) Level is Unit Level 1

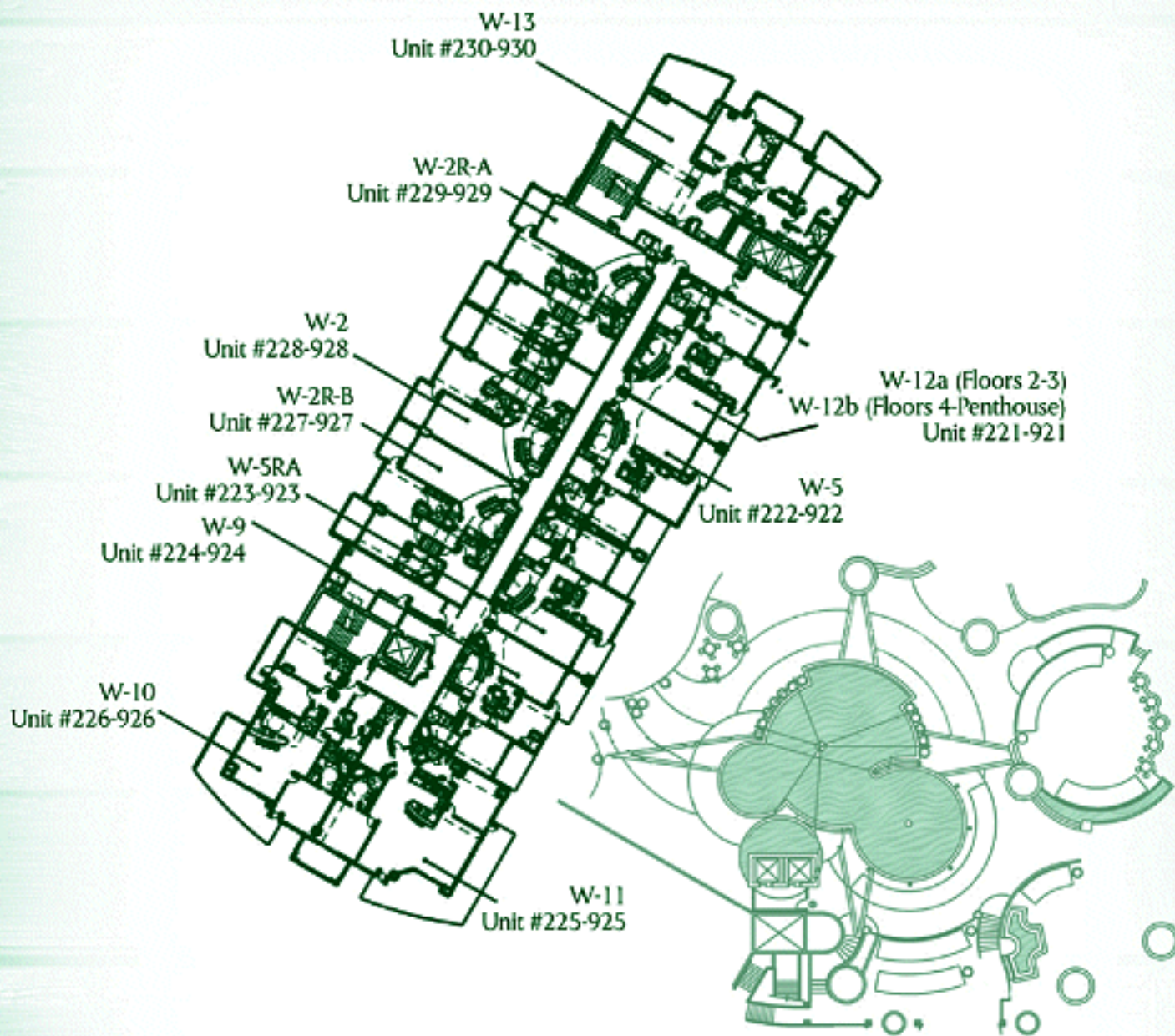

West Tower

Unit Levels 2 through 9

Tower Plan Level 8

The above drawings are conceptual only and are subject to change without notice at the discretion of the developer. The developer reserves the right to make any additions, deletions and modifications to the drawings as the developer may deem appropriate or desirable. Dimensions and square footages are approximate and may vary with actual construction. Furniture depicted is for conceptual consideration. Oral representations cannot be relied upon as correctly stating representations of the developer. For correct representations make reference to the documents required by section 718.503, Florida Statutes, to be furnished by a developer to a buyer or lessee.

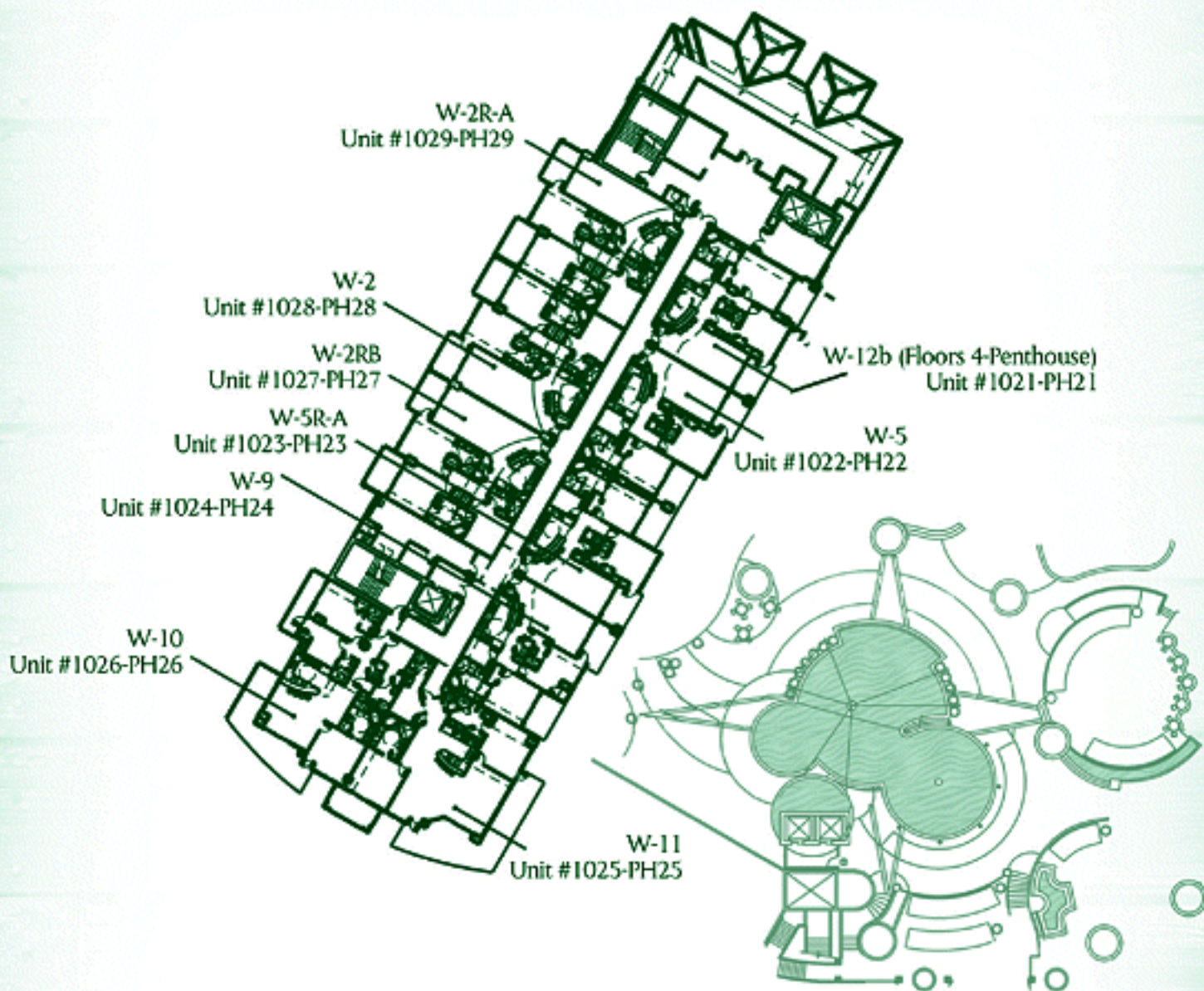

West Tower

Unit Levels 10 through Penthouse

Tower Plan Level 10

The above drawings are conceptual only and are subject to change without notice at the discretion of the developer. The developer reserves the right to make any additions, deletions and modifications to the drawings as the developer may deem appropriate or desirable. Dimensions and square footages are approximate and may vary with actual construction. Furniture depicted is for conceptual consideration. Oral representations cannot be relied upon as correctly stating representations of the developer. For correct representations make reference to the documents required by section 718.503, Florida Statutes, to be furnished by a developer to a buyer or lessee.

Note: Penthouse (PH) Level is Unit Level 13